

# SRG-300H

Mar.08,2017

[unit:mm]

This technical drawing shows the bottom view of a mechanical component. It features a circular base with a central rectangular cutout. The cutout contains four circular holes arranged in a 2x2 grid. The base is surrounded by a thick, curved rim. Various mounting points, slots, and structural features are visible, including a central vertical slot, side slots, and a central rectangular slot. The drawing is symmetrical about a vertical centerline and a horizontal centerline.

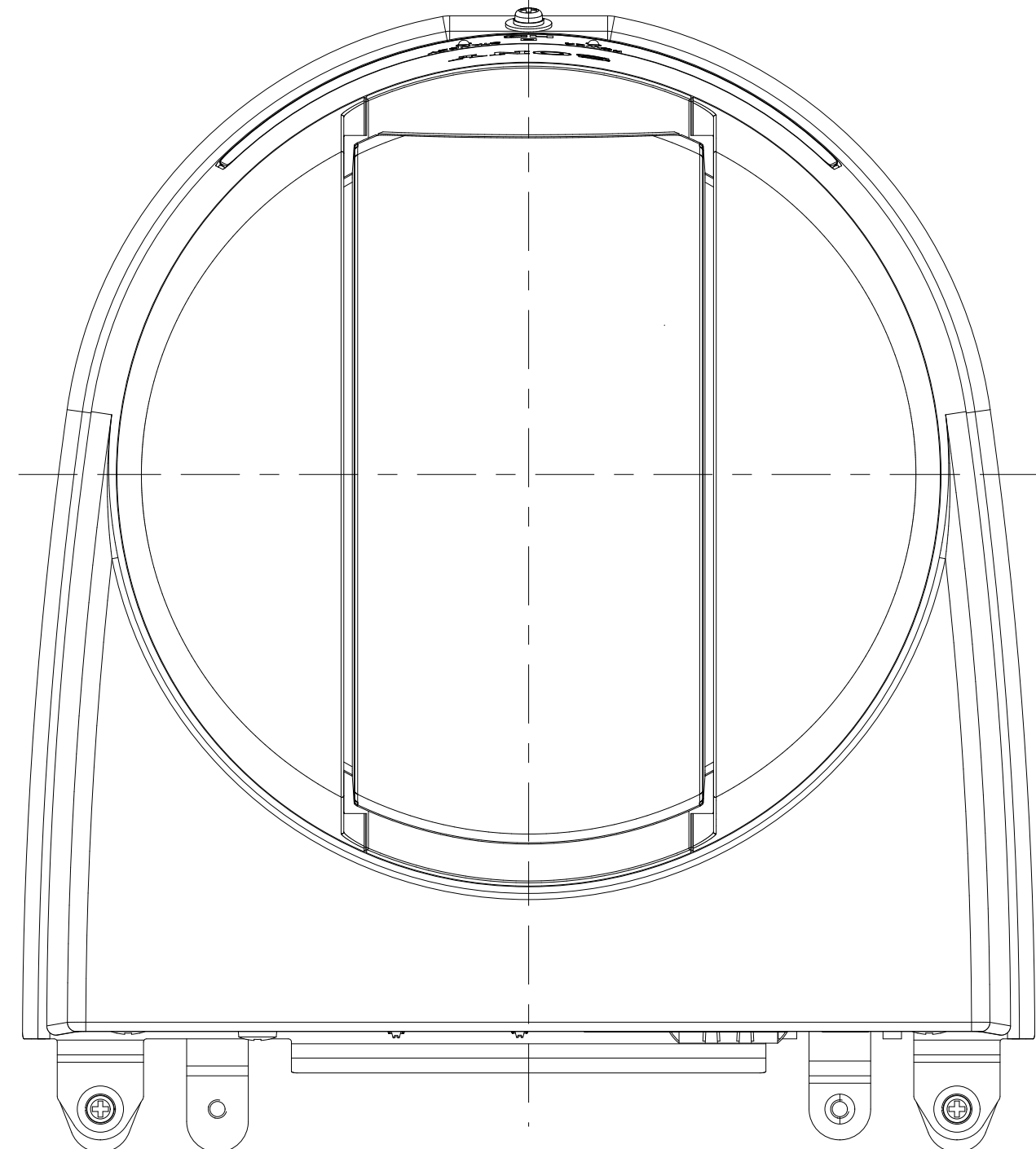
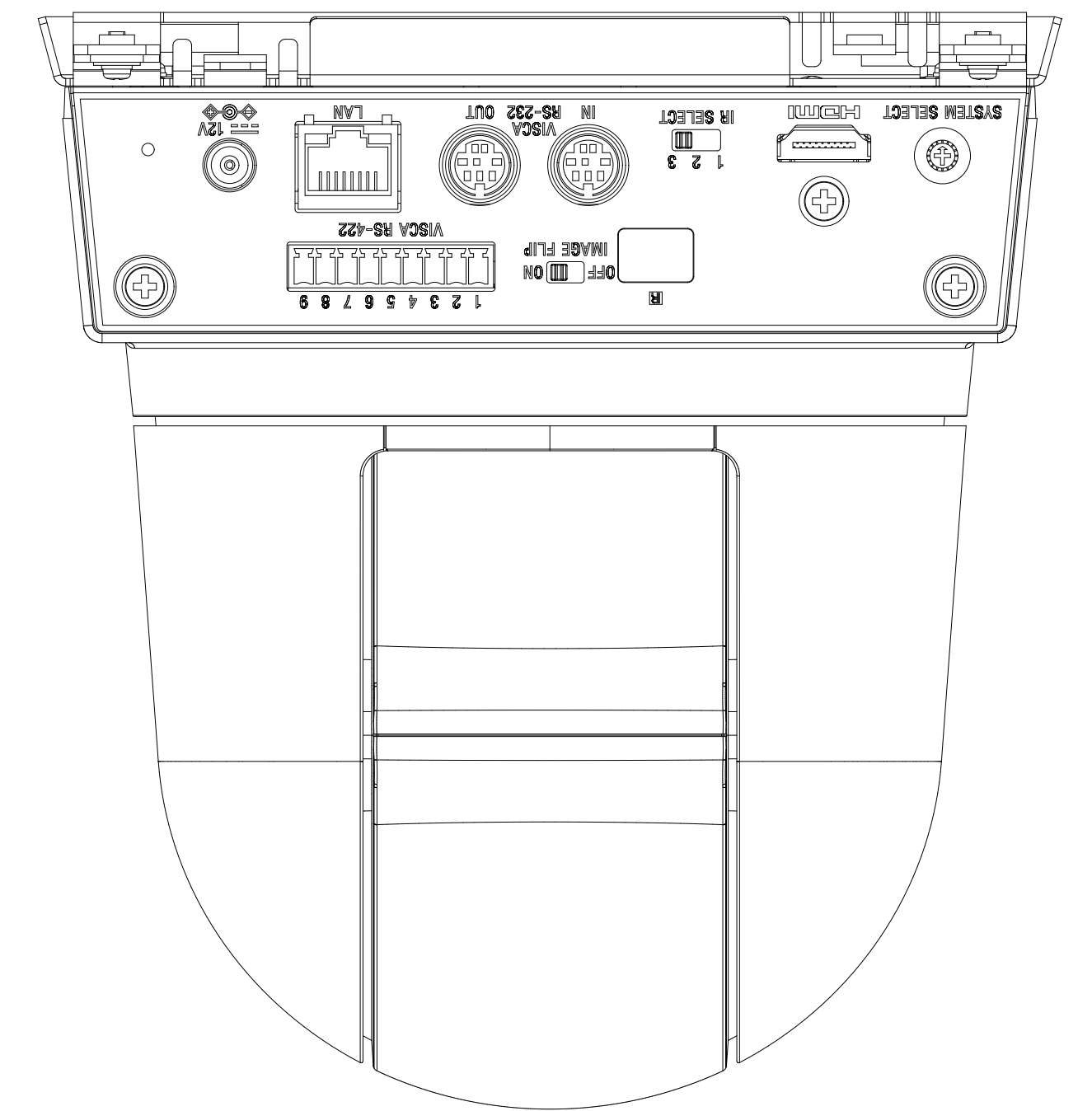
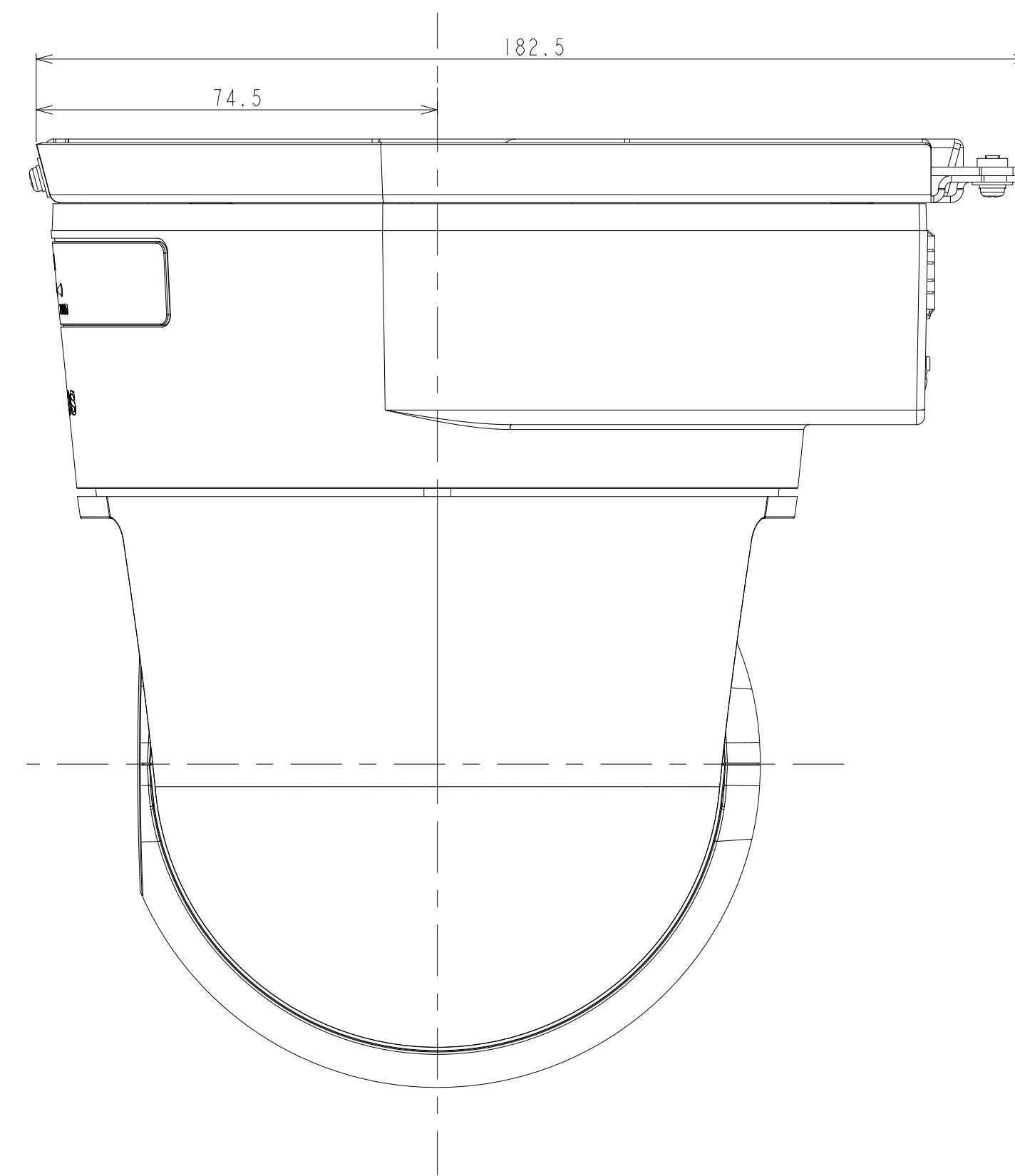
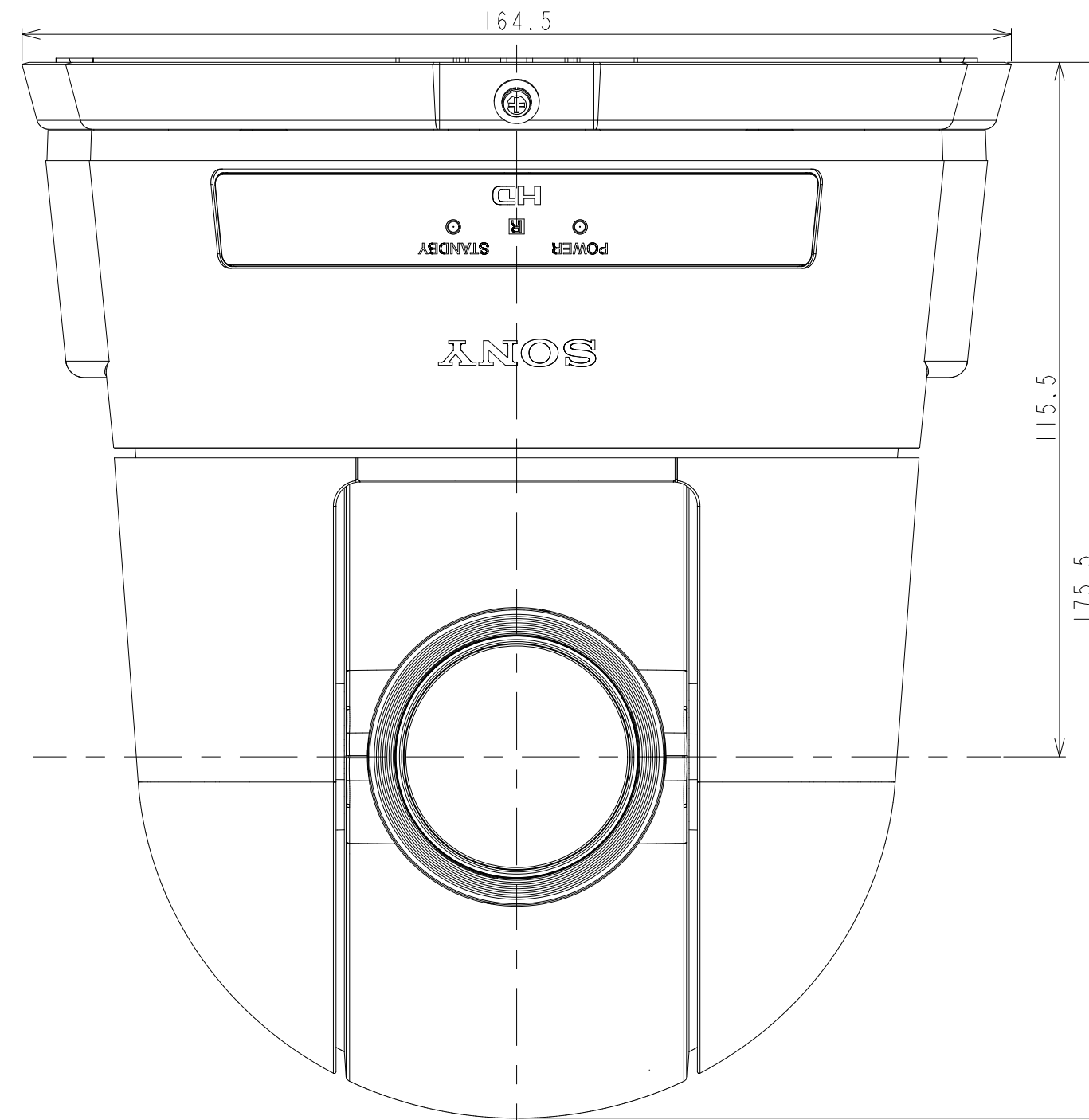
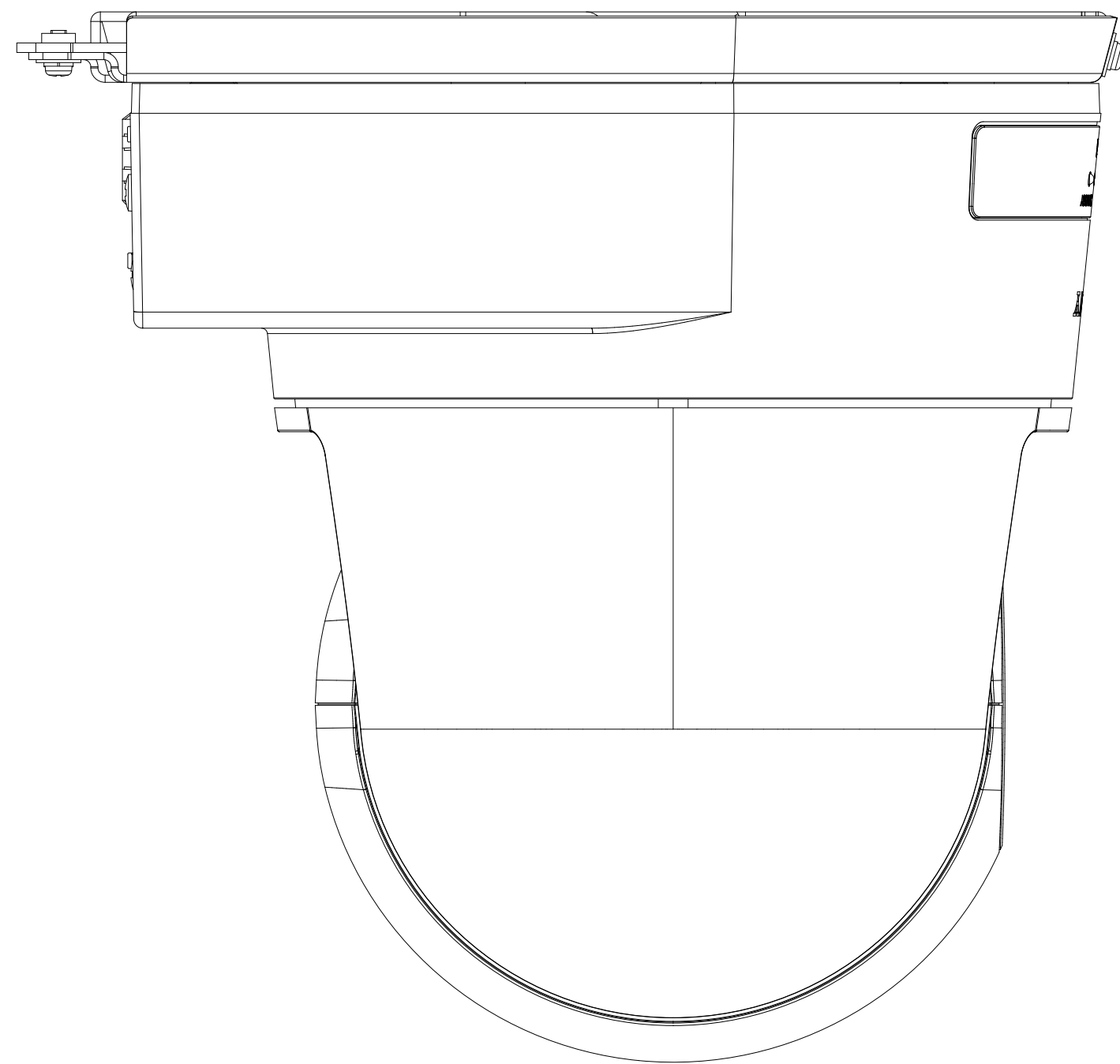

# SRG-300H

srcg-300h-170307.drw : UPDATED & PTC\_WM\_MODIFIED\_ON:D